



 verde pubblico

 parcheggio pubblico

 edifici esistenti

 perimetro PII

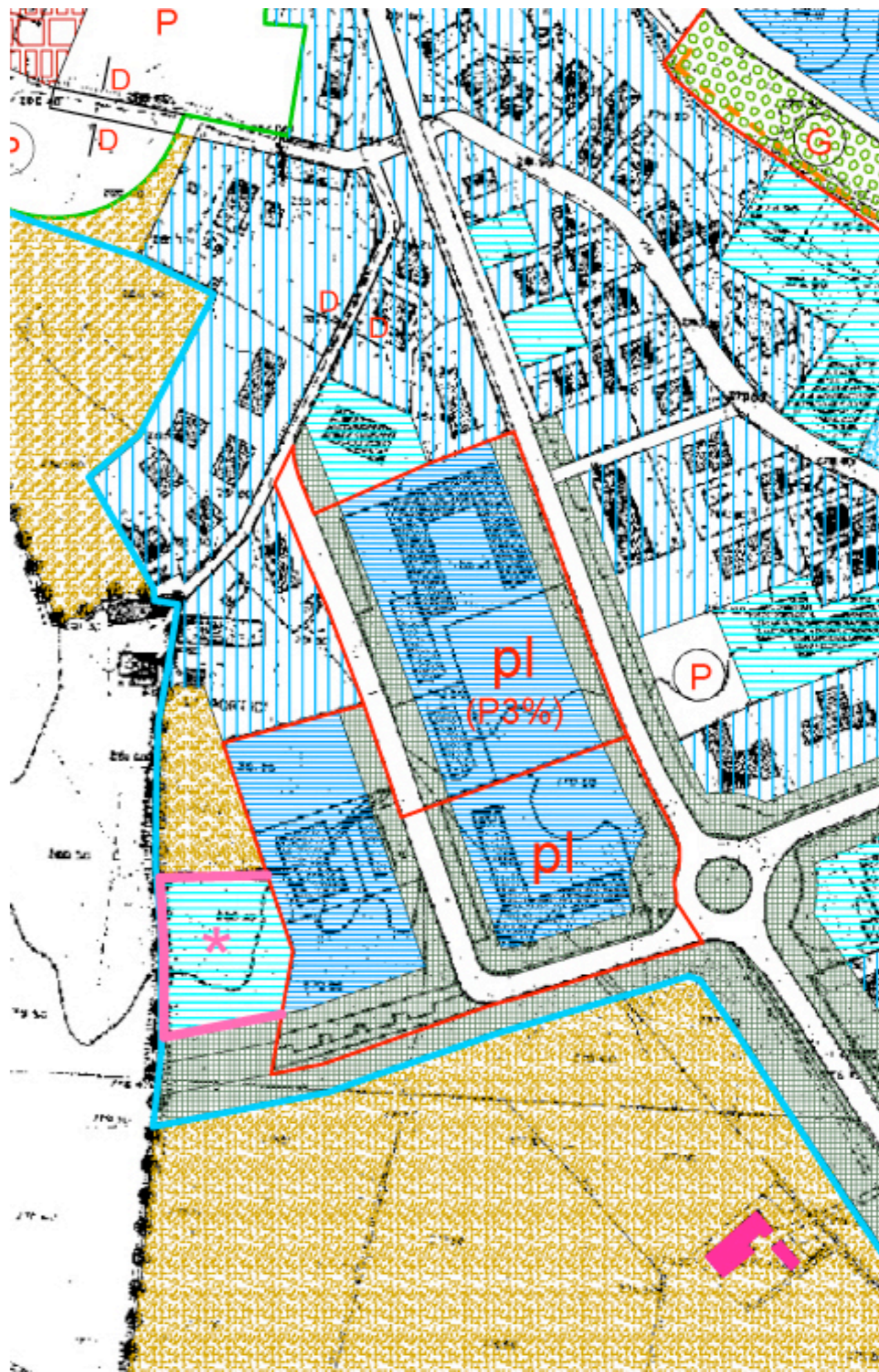
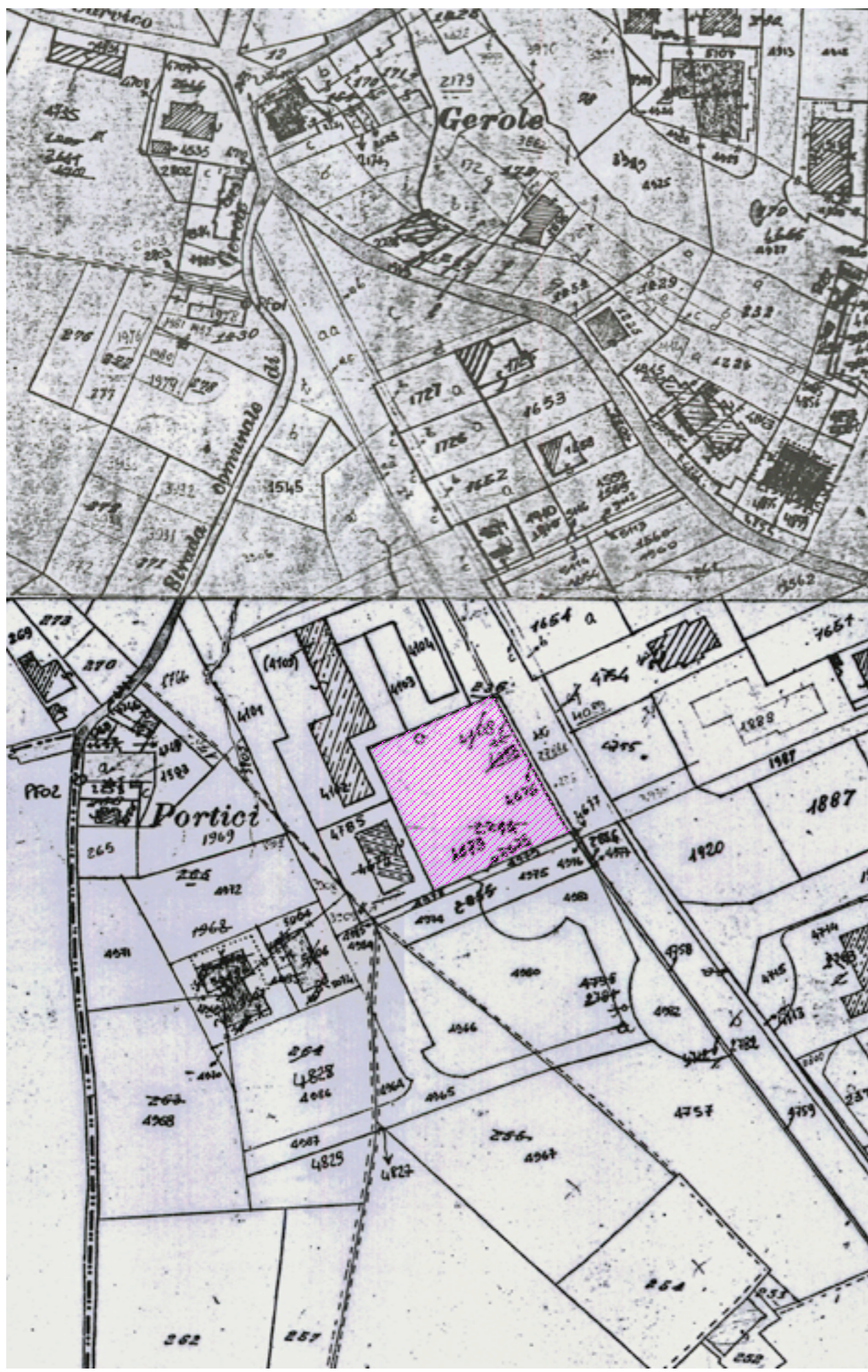

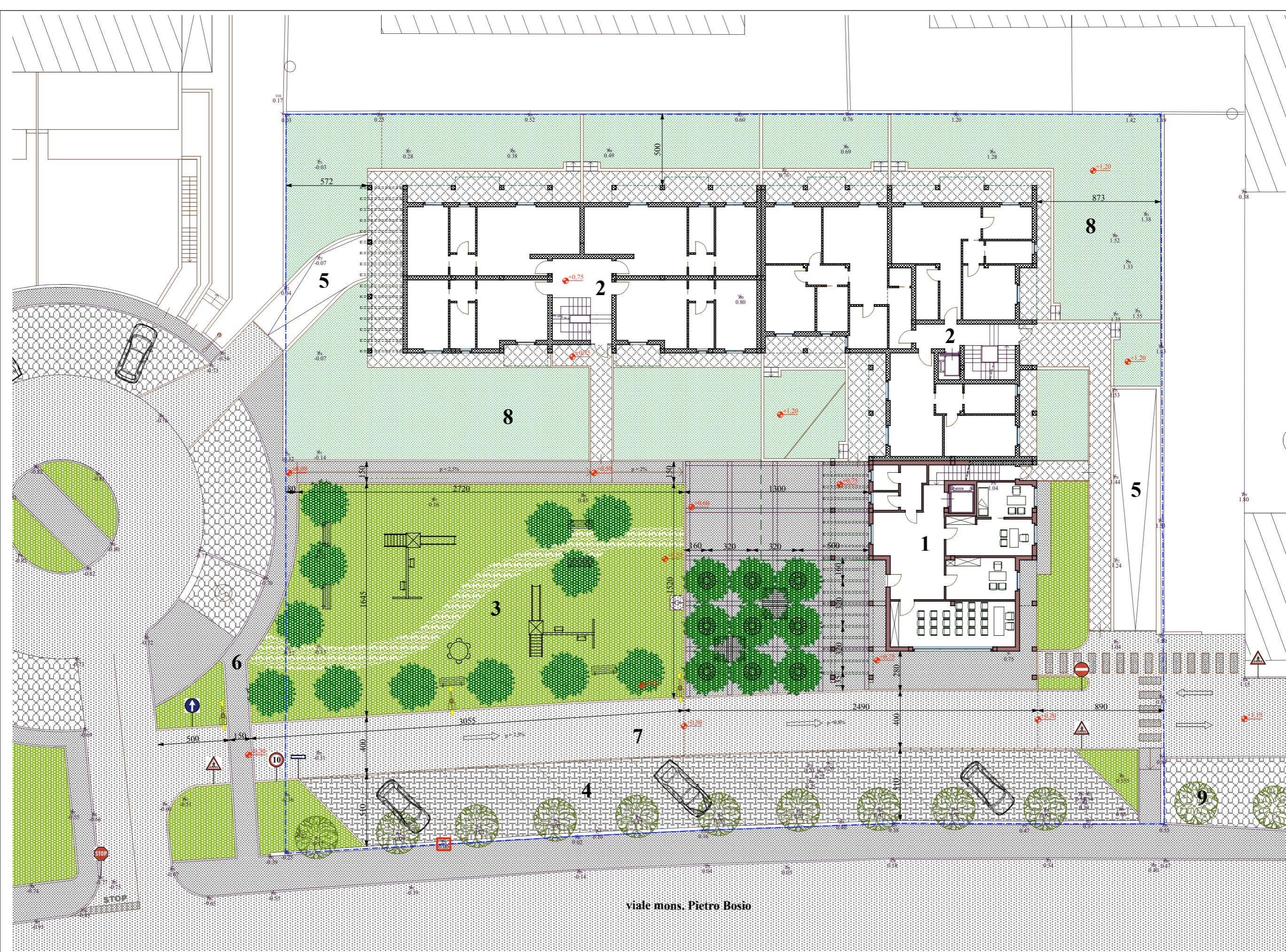

viale mons. Pietro Bosio

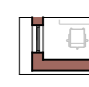
- 

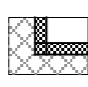
1 locali per le Associazioni
- 

2 nuovo complesso residenziale
- 

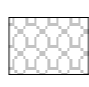
3 giardino pubblico di P.I.I.
- 

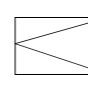
4 parcheggio pubblico di P.I.I.
- 

5 rampa di accesso interrato
- 

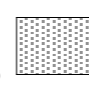
6 accesso pedonale al giardino pubblico
- 

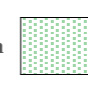
7 corsia di manovra parcheggio
- 

8 giardini privati
- 

9 piantumazione

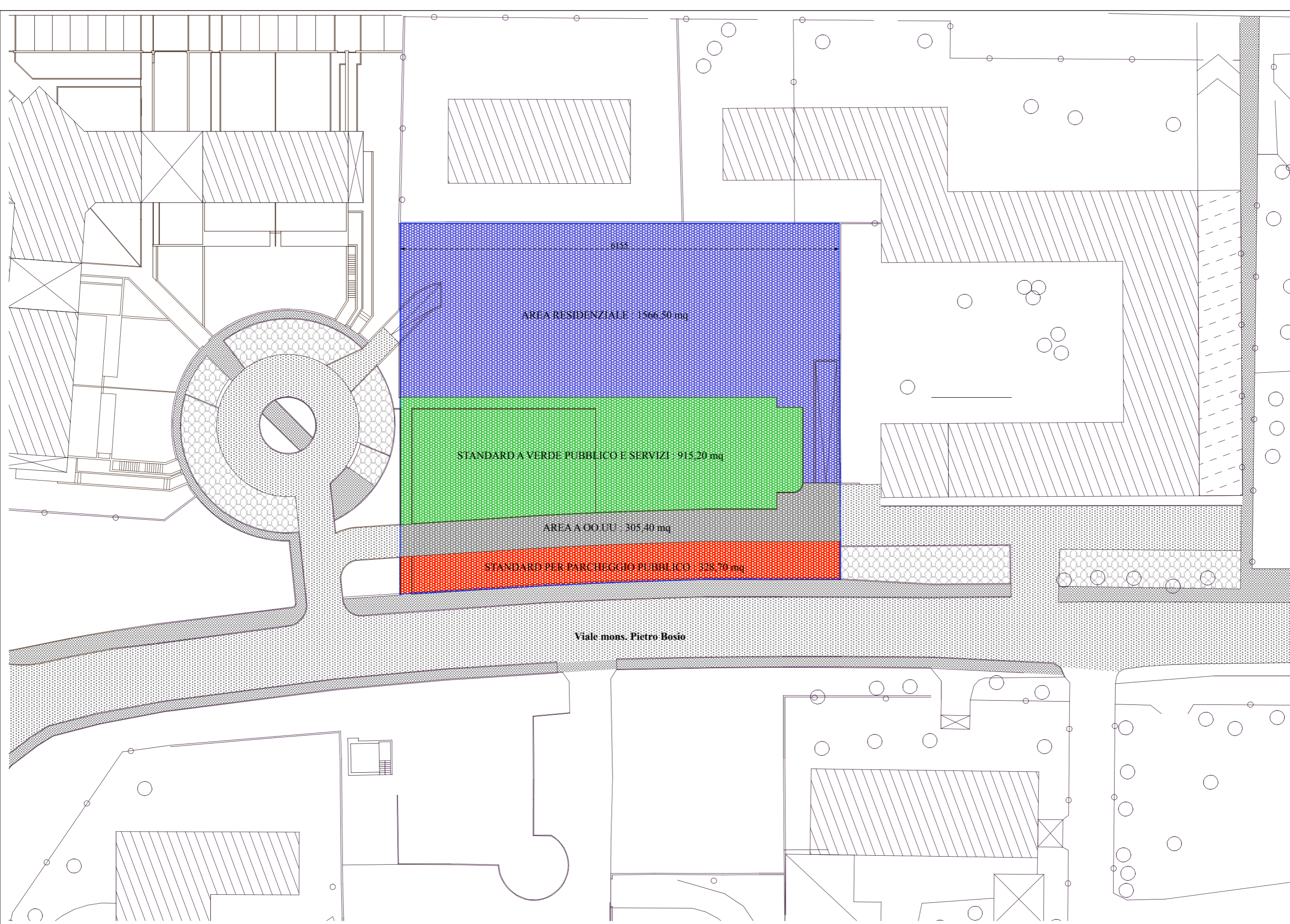

- area a verde pubblico e servizi
- area a parcheggio pubblico
- area residenziale
- aree per OO.UU.

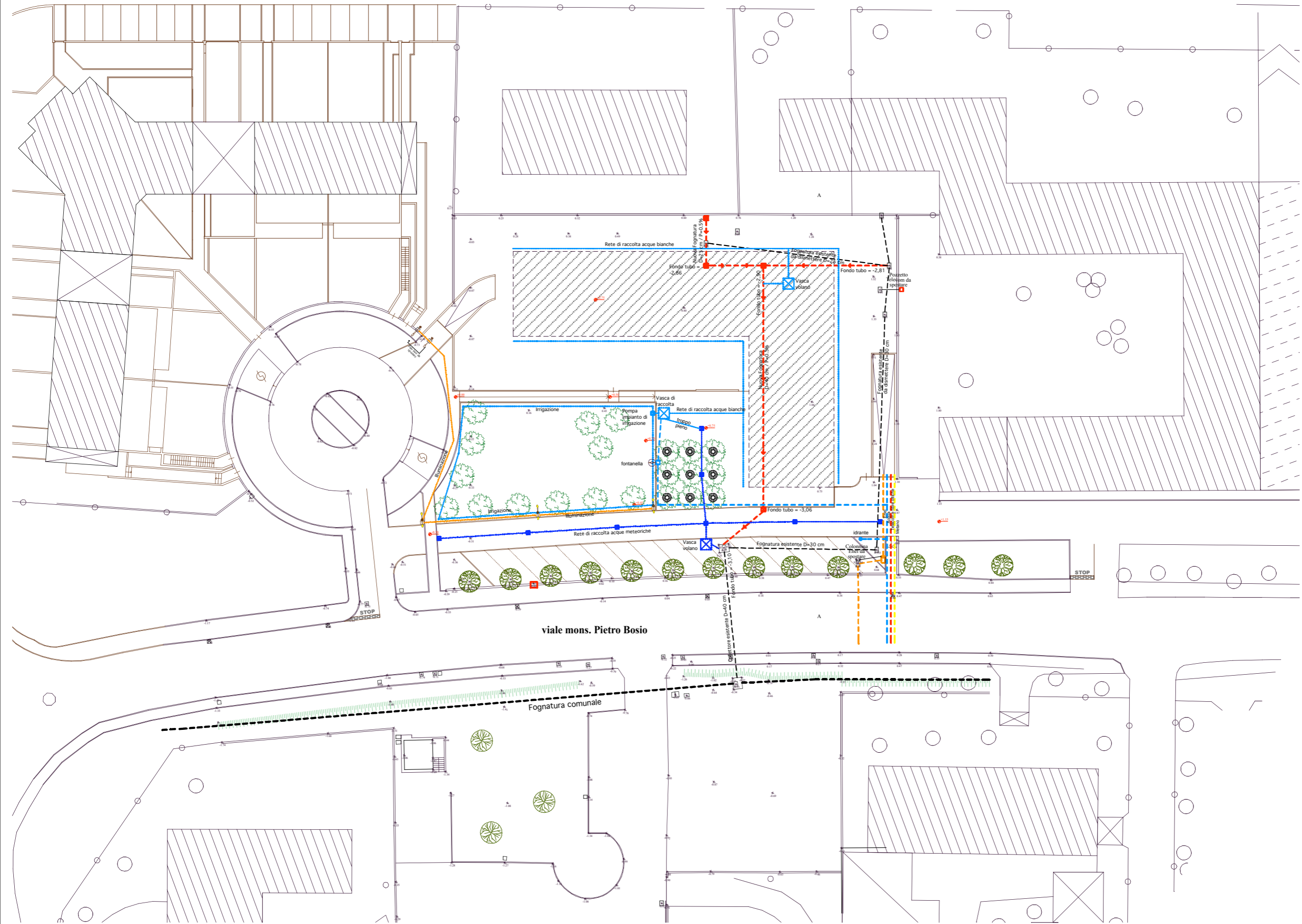

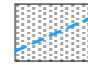
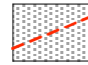
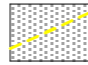
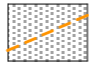
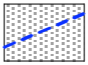
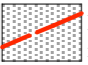
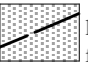

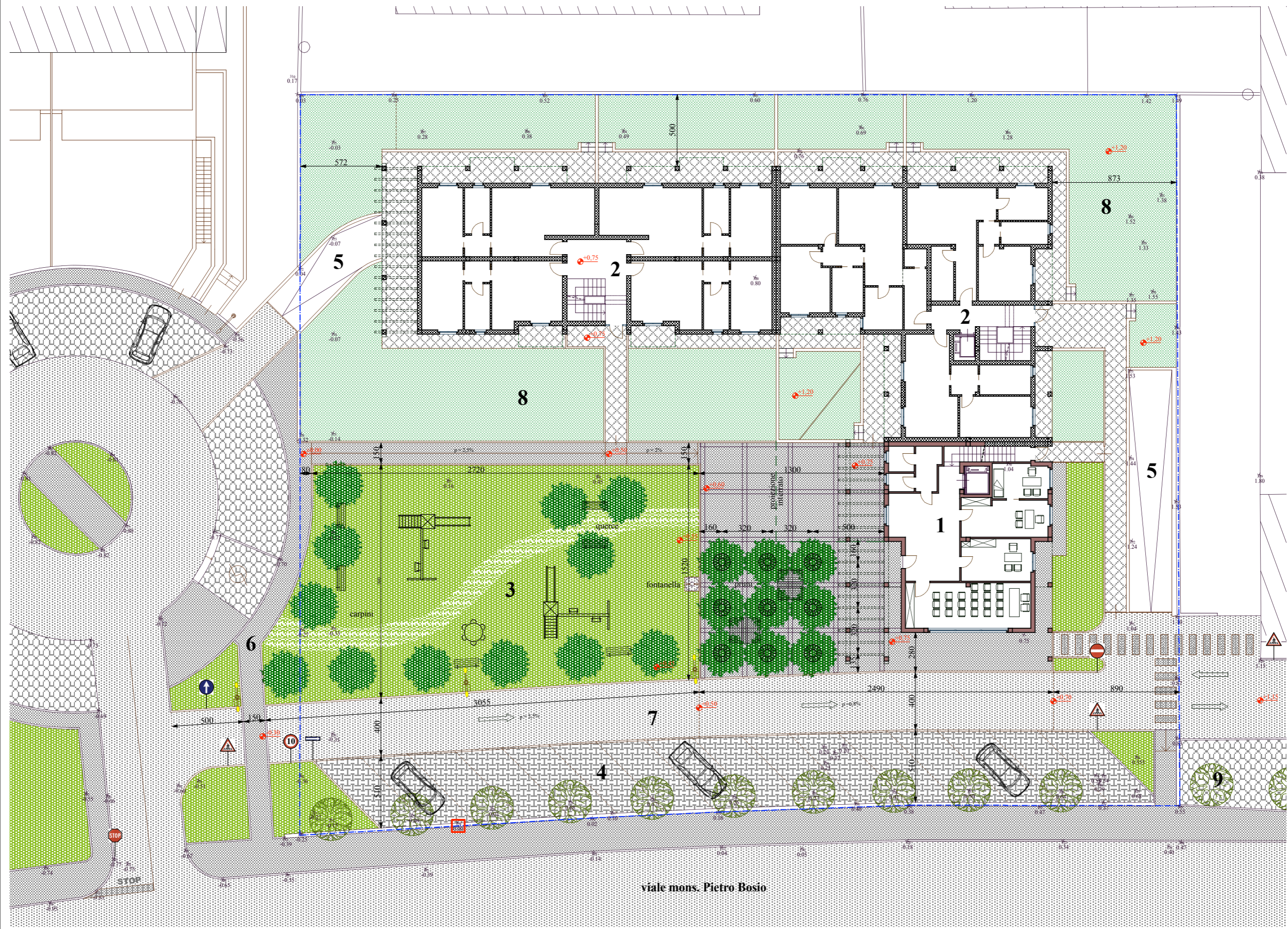
- 
 linea
acquedotto
- 
 linea
telefonica
- 
 linea
metanodotto
- 
 linea energia
elettrica
- 
 linea
tombinatura
- 
 linea
fognatura
- 
 linea
fognatura esistente

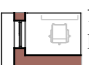

viale mons. Pietro Bosio

- 

1 locali per le Associazioni
- 

2 nuovo complesso residenziale
- 

3 giardino pubblico di P.I.I.
- 

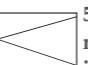
4 parcheggio pubblico di P.I.I.
- 

5 rampa di accesso interrato
- 

6 accesso pedonale al giardino pubblico
- 

7 corsia di manovra parcheggio
- 

8 giardini privati
- 

9 piantumazione

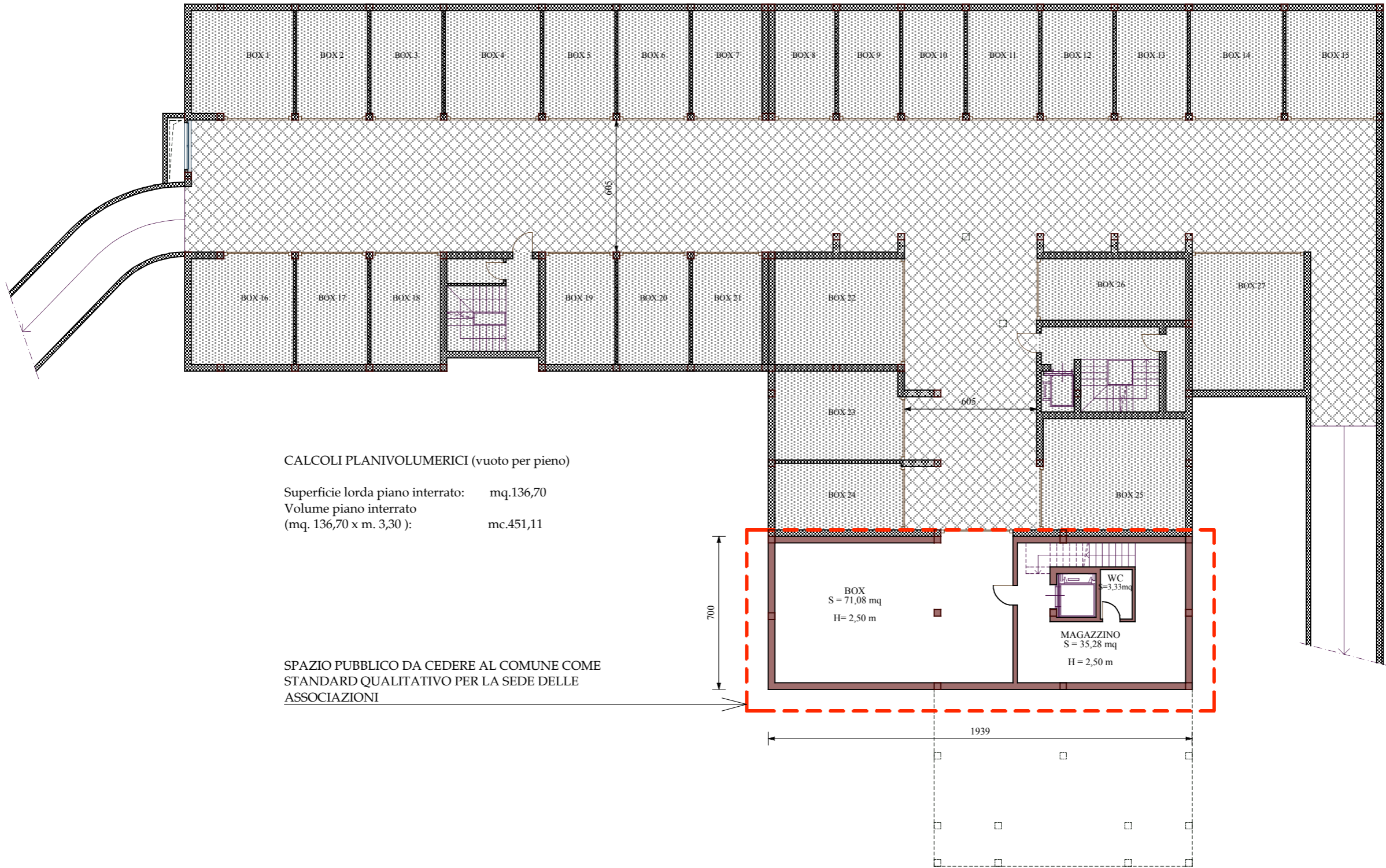

CALCOLI PLANIVOLUMERICI (vuoto per pieno)

Superficie lorda piano interrato: mq.136,70
 Volume piano interrato (mq. 136,70 x m. 3,30): mc.451,11

SPAZIO PUBBLICO DA CEDERE AL COMUNE COME STANDARD QUALITATIVO PER LA SEDE DELLE ASSOCIAZIONI

locali per le Associazioni

box per il nuovo complesso residenziale

percorsi in comune

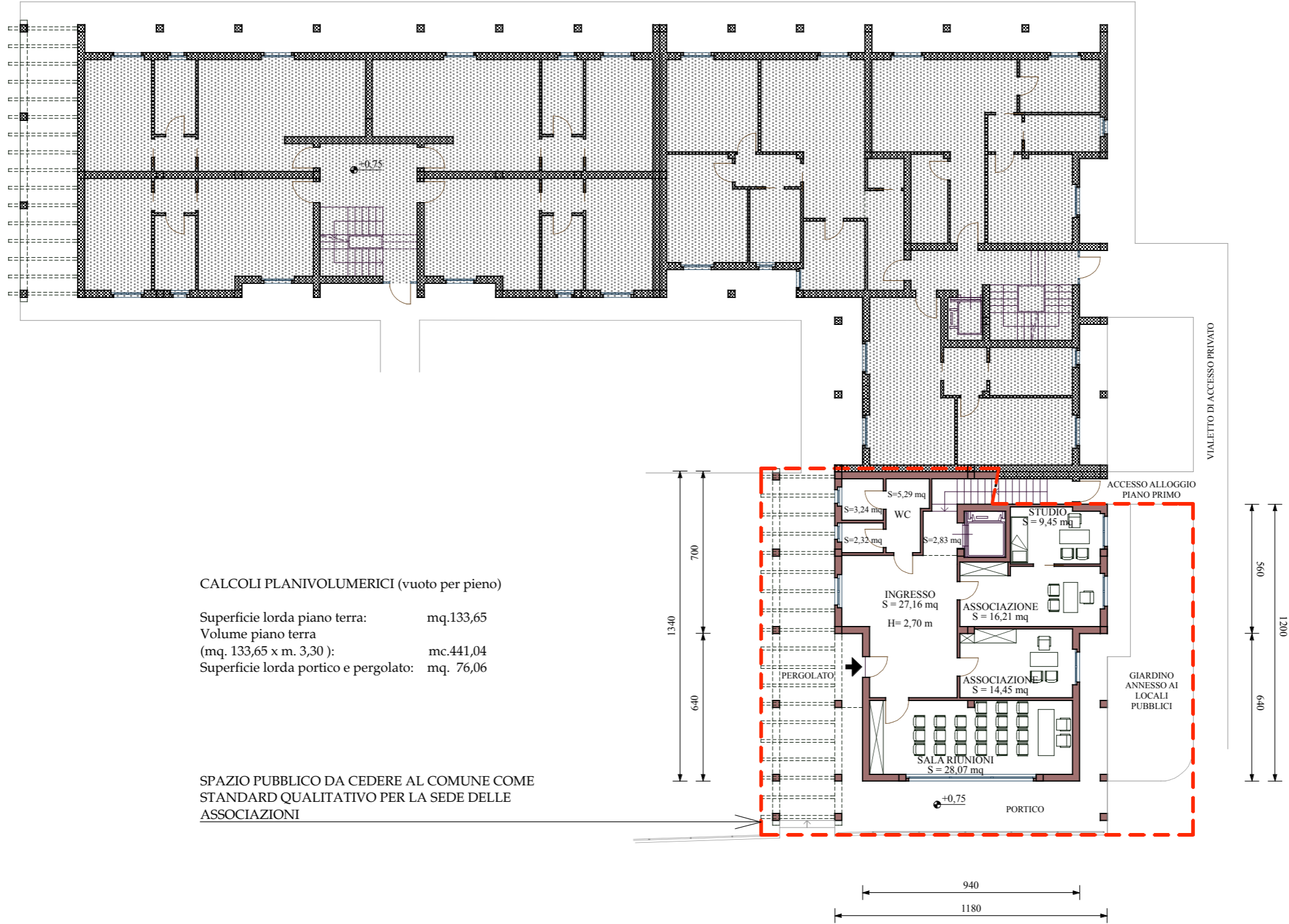

CALCOLI PLANIVOLUMERICI (vuoto per pieno)

Superficie lorda piano terra: mq.133,65
 Volume piano terra
 (mq. 133,65 x m. 3,30): mc.441,04
 Superficie lorda portico e pergolato: mq. 76,06

SPAZIO PUBBLICO DA CEDERE AL COMUNE COME
 STANDARD QUALITATIVO PER LA SEDE DELLE
 ASSOCIAZIONI



locali per le
Associazioni

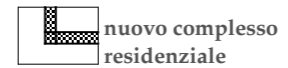

nuovo complesso
residenziale

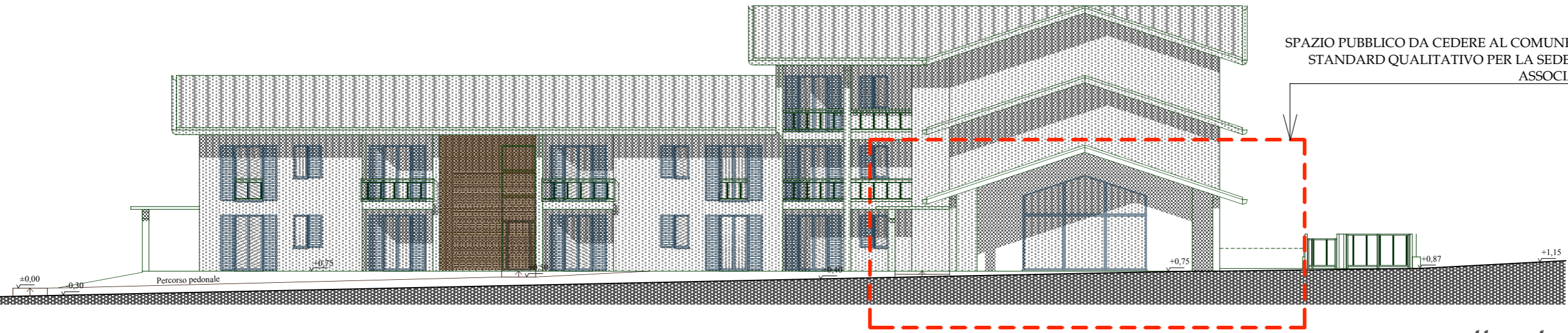

prospetto est



prospetto ovest

SPAZIO PUBBLICO DA CEDERE AL COMUNE COME STANDARD QUALITATIVO PER LA SEDE DELLE ASSOCIAZIONI

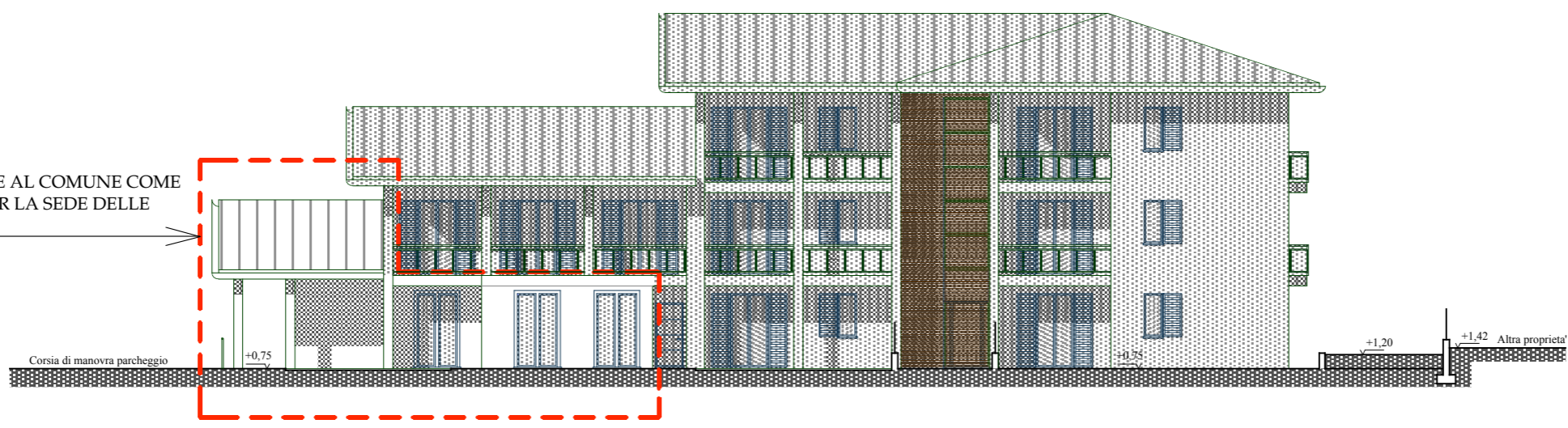

prospetto nord

SPAZIO PUBBLICO DA CEDERE AL COMUNE COME STANDARD QUALITATIVO PER LA SEDE DELLE ASSOCIAZIONI

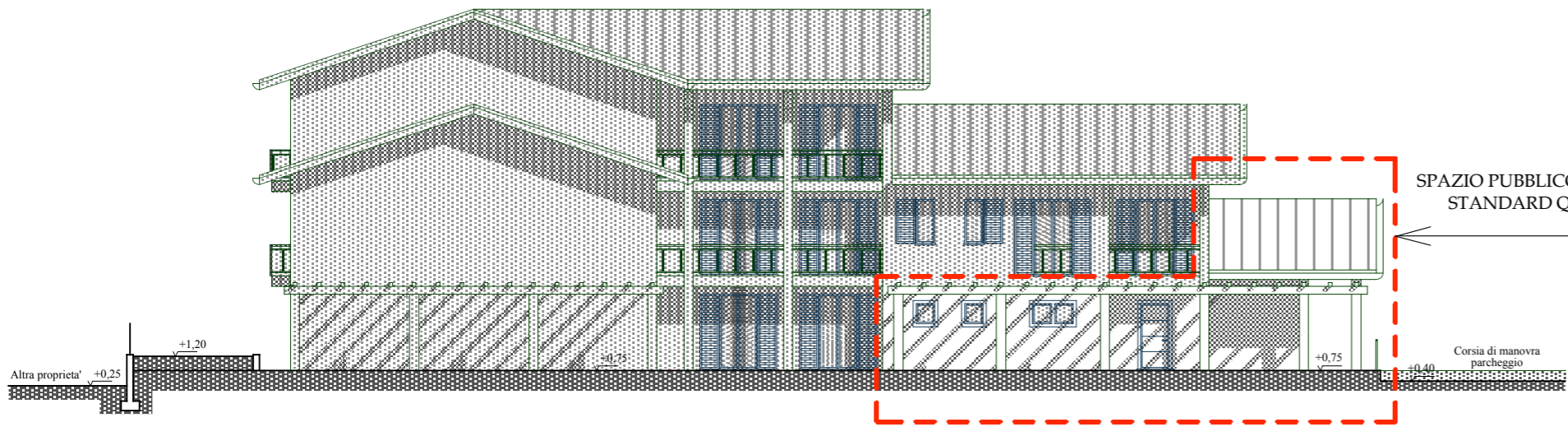

prospetto sud

SPAZIO PUBBLICO DA CEDERE AL COMUNE COME STANDARD QUALITATIVO PER LA SEDE DELLE ASSOCIAZIONI

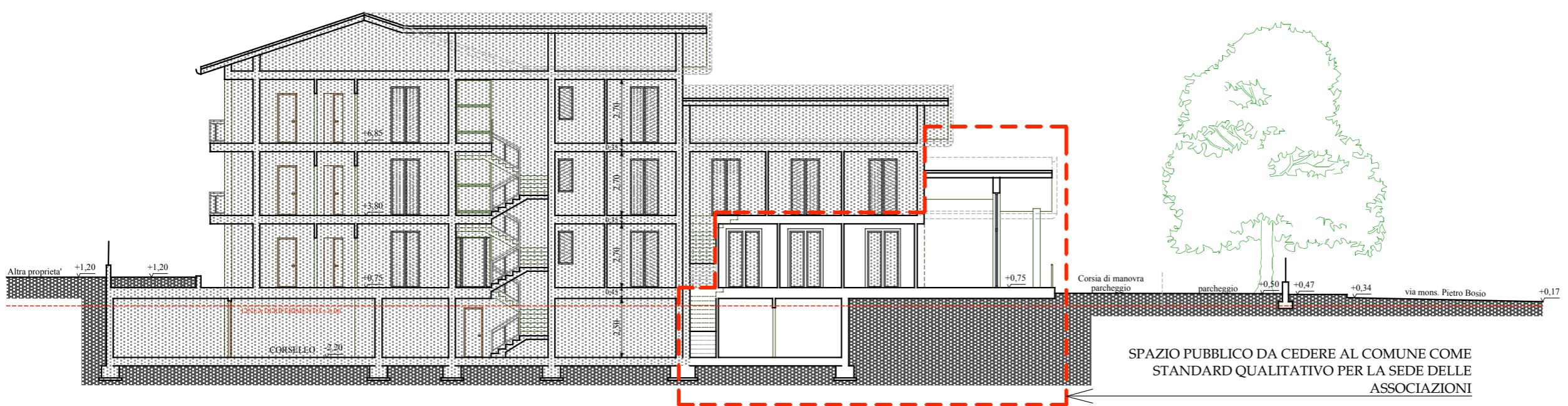

sezione A-A